

## Data Cabinets

Power Distribution Units ideally suited for data rack applications. 19" horizontal for front of rack positioning or vertical units for back of rack situations. Many product variants are available including the unique design to accommodate 8 x UK

13 Amp sockets within the 19" format.

All PDU's are manufactured from anodised aluminium extrusion fitted with tough polycarbonate accessories.

All UK 13 Amp sockets have been purposefully designed with

a bus bar linking system which reduces risk, by eliminating internal wiring & potentially loose connections. All power terminal connections on these units are a maintenance free screwless design.



## - X19 - UK 19" Horizontal Rack Mount



List No.	Description	Dim: X	Dim: Y
X194	4 way	480.5	460.5
X195	5 way	480.5	460.5
X196	6 way	480.5	460.5
X198	8 way	480.5	460.5

## - X19N - UK Neon Indicated 19" Horizontal Rack Mount



List No.	Description	Dim: X	Dim: Y
X194N	4 way	480.5	460.5
X195N	5 way	480.5	460.5
X196N	6 way	480.5	460.5
X198N	8 way	480.5	460.5

## - X19S - UK Switched 19" Horizontal Rack Mount



List No.	Description	Dim: X	Dim: Y
X194S	4 way	480.5	460.5
X195S	5 way	480.5	460.5
X196S	6 way	480.5	460.5
X198S	8 way	480.5	460.5

- 16 Amps total load.
- Supplied with 3mtrs flex to 13A UK fuse plug top.
- Red Neon Indicated Double Pole Switch.
- For alternative Plugs see 'options page 102'.

eg - **X198-32** - 32Amp rated unit c/w 32Amp IEC60309 Plug.

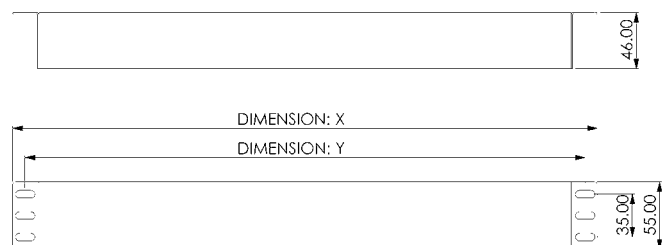

## X19E- IEC C13 19" Horizontal Rack Mount



List No.	Description	Dim: X	Dim: Y
X194E	4 way	480.5	460.5
X198E	8 way	480.5	460.5
X1912E	12 way	480.5	460.5
X1916E	16 way	480.5	460.5

## X19EN- IEC C13 Neon Indicated 19" Horizontal Rack Mount



List No.	Description	Dim: X	Dim: Y
X194EN	4 way neon	480.5	460.5
X198EN	8 way neon	480.5	460.5
X1912EN	12 way neon	480.5	460.5
X1916EN	16 way neon	480.5	460.5

## X19ES- IEC C13 Switched 19" Horizontal Rack Mount

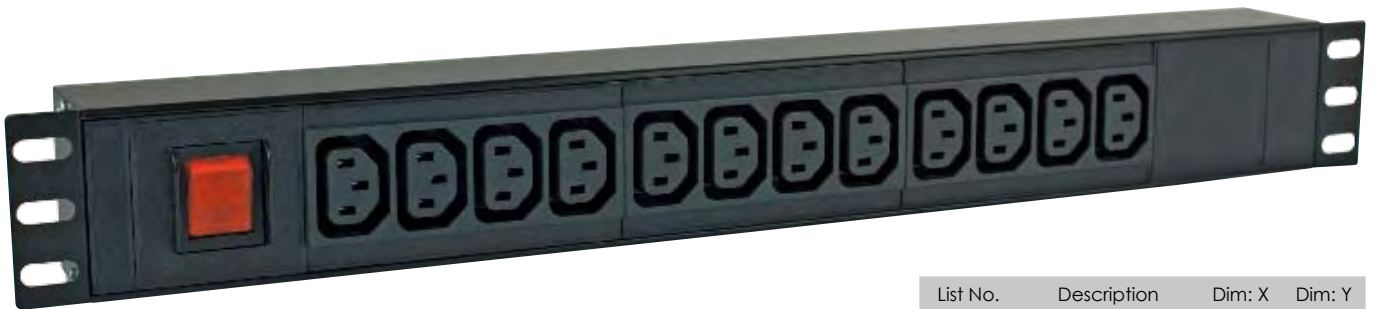

List No.	Description	Dim: X	Dim: Y
X194ES	4 way switched	480.5	460.5
X198ES	8 way switched	480.5	460.5
X1912ES	12 way switched	480.5	460.5
X1916ES	16 way switched	480.5	460.5

- 16amps total load.
- Supplied with 3mtrs flex to 13Amp UK fused plug top.
- Red Neon Indicated Double Pole Switch.
- For alternative plugs see 'options page 102'.

eg - **X198E-E** - 16Amp rated unit c/w 10Amp IEC60320 C14 Plug.

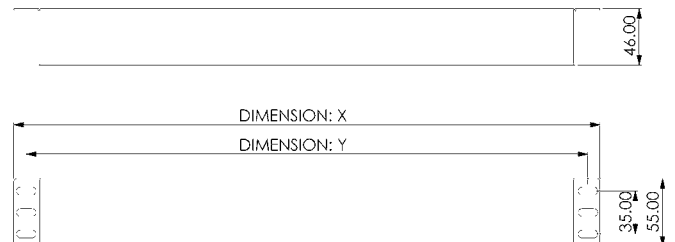

## X19C19- IEC C19 19" Horizontal Rack Mount



List No.	Description	Dim: X	Dim: Y
X194C19	4 way	480.5	460.5
X195C19	5 way	480.5	460.5
X196C19	6 way	480.5	460.5
X198C19	8 way	480.5	460.5

## X19C19N- IEC C19 Neon Indicated 19" Horizontal Rack Mount



List No.	Description	Dim: X	Dim: Y
X194C19N	4 way Neon	480.5	460.5
X195C19N	5 way Neon	480.5	460.5
X196C19N	6 way Neon	480.5	460.5
X198C19N	8 way Neon	480.5	460.5

## X19C19S- IEC C19 Switched 19" Horizontal Rack Mount



List No.	Description	Dim: X	Dim: Y
X194C19S	4 way Switched	480.5	460.5
X195C19S	5 way Switched	480.5	460.5
X196C19S	6 way Switched	480.5	460.5
X198C19S	8 way Switched	480.5	460.5

- 16amps total load.
- Supplied with 3mtrs flex to 13Amp UK fused Plug Top.
- Red Neon Indicated Double Pole Switch.
- For alternative Plugs see 'options page 102'.

eg - **X198C19-C20** - 16Amp rated unit c/w 16Amp IEC60320 C20 Plug.

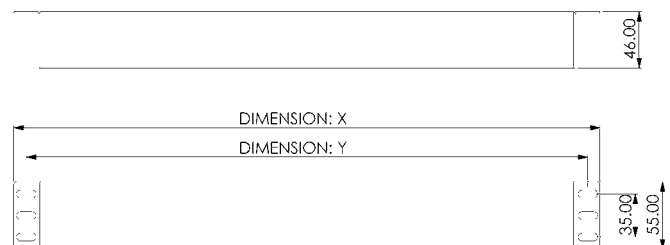

## X19COMBI - UK / IEC Combination 19" Horizontal Rack Mount

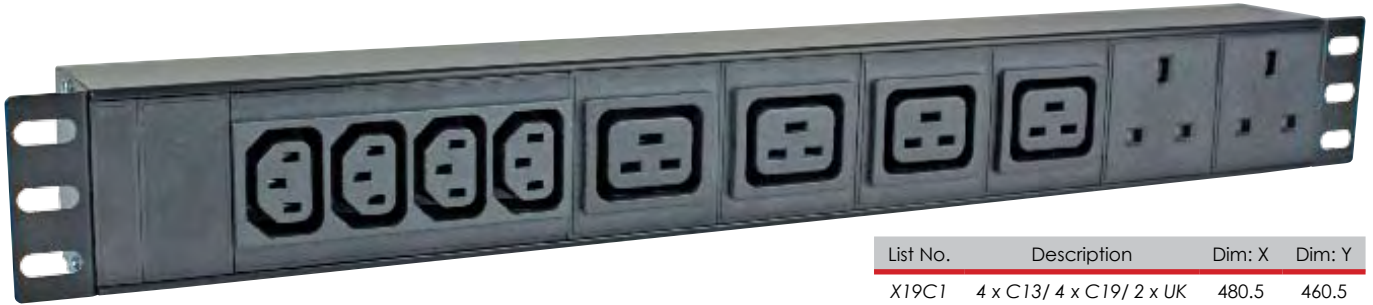

List No.	Description	Dim: X	Dim: Y
X19C1	4 x C13/ 4 x C19/ 2 x UK	480.5	460.5
X19C2	4 x C13/ 2 x C19/ 4 x UK	480.5	460.5
X19C3	8 x C13/ 3 x C19	480.5	460.5
X19C4	4 x C13/ 6 x UK	480.5	460.5

## X19COMBI - UK / IEC Neon Indicated Combination 19" Horizontal Rack Mount



List No.	Description	Dim: X	Dim: Y
X19C1N	4 x C13/ 4 x C19/ 2 x UK neon	480.5	460.5
X19C2N	4 x C13/ 2 x C19/ 4 x UK neon	480.5	460.5
X19C3N	8 x C13/ 3 x C19 neon	480.5	460.5
X19C4N	4 x C13/ 6 x UK neon	480.5	460.5

## X19COMBI - UK / IEC Switched Combination 19" Horizontal Rack Mount



List No.	Description	Dim: X	Dim: Y
X19C1S	4 x C13/ 4 x C19/ 2 x UK switch	480.5	460.5
X19C2S	4 x C13/ 2 x C19/ 4 x UK switch	480.5	460.5
X19C3S	8 x C13/ 3 x C19 switch	480.5	460.5
X19C4S	4 x C13/ 5 x UK switch	480.5	460.5

- 16amps total load.
- Supplied with 3mtrs flex to 13A UK fused plug top.
- Red neon indicated double pole switch.
- For alternative Plugs see 'options page 102'.

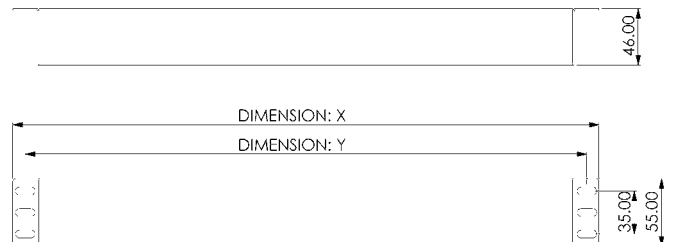

## X19SCH - European Schuko CEE7 19" Horizontal Rack Mount



- 16amps total load.
- Supplied as standard with 3mtrs flex to CEE7 Plug.
- For alternative Plugs see 'options page 102'.

List No.	Description	Dim: X	Dim: Y
X194SCH	4 way	480.5	460.5
X195SCH	5 way	480.5	460.5
X196SCH	6 way	480.5	460.5
X198SCH	8 way	480.5	460.5

## X19FRE - French Belgian 19" Horizontal Rack Mount



- 16amps total load.
- Supplied as standard with 3mtrs flex to CEE7 Plug.
- For alternative Plugs see 'options page 102'.

List No.	Description	Dim: X	Dim: Y
X194FREN	4 way neon	480.5	460.5
X195FREN	5 way neon	480.5	460.5
X196FREN	6 way neon	480.5	460.5
X198FREN	8 way neon	480.5	460.5

## X194Q - UK Sequential start 19" Horizontal Rack Mount



List No.	Description	Dim: X	Dim: Y
X194Q	6 way sequential	480.5	460.5

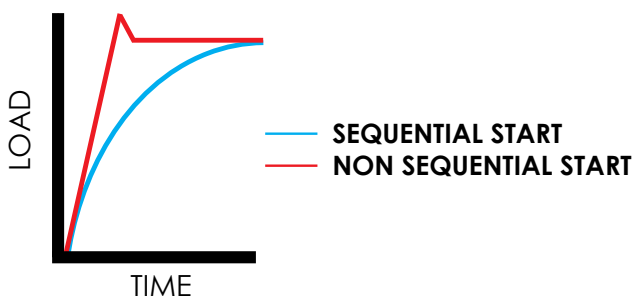

- 16amps total load.
- Supplied with 3mtrs flex to 13A UK fused plug Top.
- For alternative Plugs see 'options page 30'

Initial power up surges can cause circuit overloads, sequential start PDU's with 1 second per socket start intervals can even up loads & avoid costly upgrades.

## XAL - Vertical Rack Mount Angled Left



- 16 Amps total load
- Supplied with 3mtrs flex to 13A UK fused plug top.
- Red Neon Indicated Double Pole Switch
- For alternative Plugs see 'options page 102'

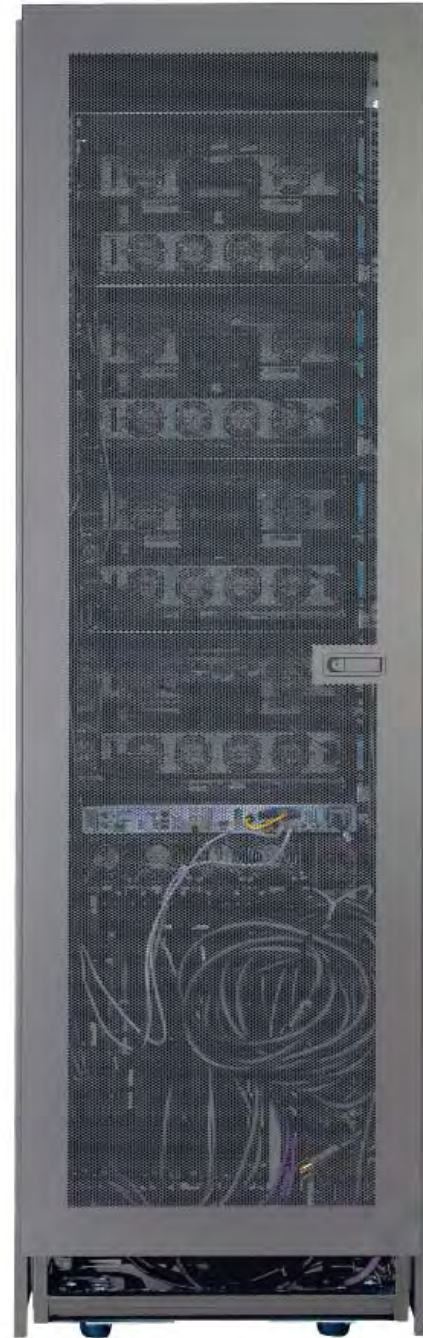

## XAL - Vertical Rack Mount Angled Left

List No.	Description	Dim: X	Dim: Y	List No.	Description	Dim: X	Dim: Y
XAL4	4 way	367	326	XAL10	10 way	743	723
XAL5	5 way	429	409	XAL12	12 way	867	847
XAL6	6 way	493	473	XAL15	15 way	1055	1035
XAL8	8 way	617	597	XAL20	20 way	1367	1347

## XALN - Vertical Rack Mount Angled left with Neon

List No.	Description	Dim: X	Dim: Y	List No.	Description	Dim: X	Dim: Y
XAL4N	4 way neon	367	326	XAL10N	10 way neon	743	723
XAL5N	5 way neon	429	409	XAL12N	12 way neon	867	847
XAL6N	6 way neon	493	473	XAL15N	15 way neon	1055	1035
XAL8N	8 way neon	617	597	XAL20N	20 way neon	1367	1347

## XALS - Vertical Rack Mount Angled Left Switched

List No.	Description	Dim: X	Dim: Y	List No.	Description	Dim: X	Dim: Y
XAL4S	4 way switch	367	326	XAL10S	10 way switch	743	723
XAL5S	5 way switch	429	409	XAL12S	12 way switch	867	847
XAL6S	6 way switch	493	473	XAL15S	15 way switch	1055	1035
XAL8S	8 way switch	617	597	XAL20S	20 way switch	1367	1347

## XAR - Vertical rack mount Angled Right

Angled units allow plug leads to fall left or right to the sides of the PDU which facilitates individual removal & increased density of sockets used.

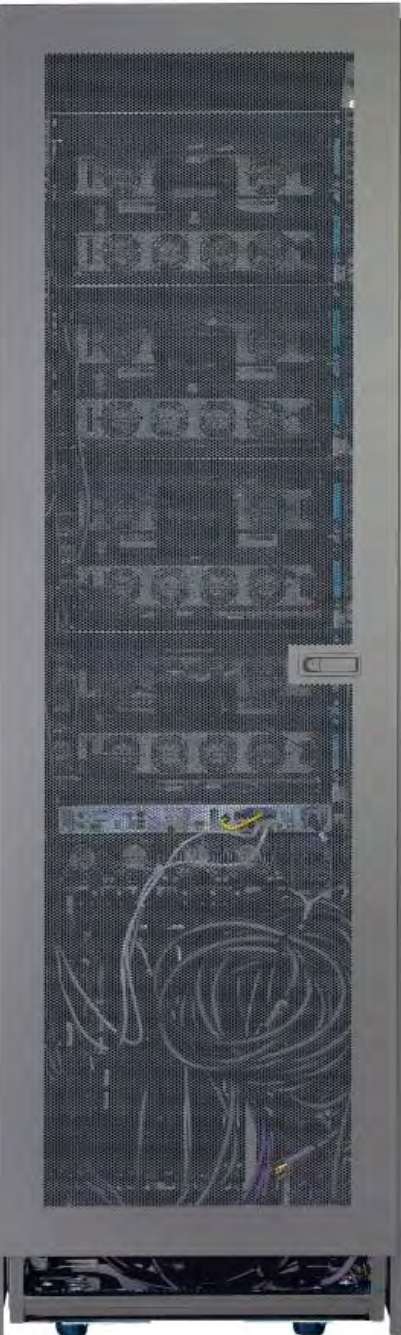

### XAR - Vertical Rack Mount Angled Right

List No.	Description	Dim: X	Dim: Y	List No.	Description	Dim: X	Dim: Y
XAR4	4 way	367	326	XAR10	10 way	743	723
XAR5	5 way	429	409	XAR12	12 way	867	847
XAR6	6 way	493	473	XAR15	15 way	1055	1035
XAR8	8 way	617	597	XAR20	20 way	1367	1347

### XARN - Vertical Rack Mount Angled Right with Neon

List No.	Description	Dim: X	Dim: Y	List No.	Description	Dim: X	Dim: Y
XAR4N	4 way neon	367	326	XAR10N	10 way neon	743	723
XAR5N	5 way neon	429	409	XAR12N	12 way neon	867	847
XAR6N	6 way neon	493	473	XAR15N	15 way neon	1055	1035
XAR8N	8 way neon	617	597	XAR20N	20 way neon	1367	1347

### XARS - Vertical Rack Mount Angled Right Switched

List No.	Description	Dim: X	Dim: Y	List No.	Description	Dim: X	Dim: Y
XAR4S	4 way switch	367	326	XAR10S	10 way switch	743	723
XAR5S	5 way switch	429	409	XAR12S	12 way switch	867	847
XAR6S	6 way switch	493	473	XAR15S	15 way switch	1055	1035
XAR8S	8 way switch	617	597	XAR20S	20 way switch	1367	1347

## Ammeter Adaptors -



List No.	Description
AM113	UK Ammeter Adaptor



List No.	Description
AM132	IEC 60309 32A Ammeter Adaptor
AM116	IEC 60309 16A Ammeter Adaptor



List No.	Description
AM1C19	IEC 60320 C19 Ammeter Adaptor



List No.	Description
AM1C13	IEC 60320 C13 Ammeter Adaptor

Convert a standard PDU to a monitored unit with an in-line Ammeter Adaptor.



## 3 Phase Power -



32 Amp 415V to 3 sets of 8 IEC C13 sockets with a local monitor ammeter that gives a continuous scrolling reading of all three phases.

Three Phase is the most efficient way of generating and distributing electricity. By delivering 3 Phase direct to rack instead of reverting to single phase at the building entry point has many advantages:

- 3 Phase cabling uses less space than single phase and so allows for future expansion
- Less Copper is used overall which lowers material installation costs.
- Installation time is quicker and therefore less costly.
- Balanced 3 Phase power is more cost effective over single phase.



## XHUSA - North American 5-15R Vertical Rack Mount



List No.	Description	Dim: X	Dim: Y	List No.	Description	Dim: X	Dim: Y
XH4USA	4 way	305	285	XH10USA	10 way	605	585
XH5USA	5 way	355	335	XH12USA	12 way	705	685
XH6USA	6 way	405	385	XH15USA	15 way	855	835
XH8USA	8 way	505	485	XH20USA	20 way	1105	1085

- 15amps total load.
- Supplied as standard with 3mtrs flex with Nema 5-15R Plug.
- For alternative Plugs see 'options page 102'.

## XHEC19- IEC C13 / IEC C19 Vertical Rack Mount



- 16amps total load.
- Supplied with 3mtrs flex to 13Amp UK fused plug top.
- For alternative plugs see 'options page 102'.

List No.	Description	Dim: X	Dim: Y
XH12E4C19	12 x C13 / 4 x C19	668	648
XH16E4C19	16 x C13 / 4 x C19	768	748
XH20E4C19	20 x C13 / 4 x C19	868	858
XH24E4C19	24 x C13 / 4 x C19	968	948

## XHE- IEC C13 Vertical Rack Mount



- 16amps total load.
- Supplied with 3mtrs flex to 13Amp UK fused plug top.
- For alternative plugs see 'options page 102'.

List No.	Description	Dim: X	Dim: Y
XH12E	12 way	468	448
XH16E	16 way	568	548
XH20E	20 way	668	648
XH24E	24 way	768	748

## XHSCH - Schuko CEE7 Vertical Rack Mount



- 16amps total load.
- Supplied as standard with 3mtrs flex to CEE7 Plug.
- For alternative Plugs see 'options page 102'.

List No.	Description	Dim: X	Dim: Y	List No.	Description	Dim: X	Dim: Y
XH4SCH	4 way	305	285	XH10SCH	10 way	605	585
XH5SCH	5 way	355	335	XH12SCH	12 way	705	685
XH6SCH	6 way	405	385	XH15SCH	15 way	855	835
XH8SCH	8 way	505	485	XH20SCH	20 way	1105	1085

## XHFRE - French Belgian Vertical Rack Mount



- 16amps total load.
- Supplied as standard with 3mtrs flex to CEE7 Plug.
- For alternative Plugs see 'options page 102'.

List No.	Description	Dim: X	Dim: Y	List No.	Description	Dim: X	Dim: Y
XH4FRE	4 way	305	285	XH10FRE	10 way	605	585
XH5FRE	5 way	355	335	XH12FRE	12 way	705	685
XH6FRE	6 way	405	385	XH15FRE	15 way	855	835
XH8FRE	8 way	505	485	XH20FRE	20 way	1105	1085



